

Playhouse, GreenLine

BASIC752



With its child scale size the playhouse is a play motivator for the youngest. The open ends and walls widen the play space, making room for a lot of children playing from all sides. The table and benches provide a great meeting point for children, again and again. The high desks and the openings inside and outside inspire classic dramatic play, such as shop and home. Thus

the Playhouse invites and retains children's role play. Dramatic play is well-known to stimulate children's language skills and thinking skills, which are crucial in early childhood development of cognition. Themes such as house and shop, which young children recognise, set a frame for mimicking and elaborating on social interaction, training

children's understanding of the world. The dramatic play trains communication, language skills and social skills such as negotiation and empathy.

| Item no. BASIC752-3418P | |
|-----------------------------|---|
| General Product Information | |
| Dimensions LxWxH | 152x142x147 cm |
| Age group | 6m+ |
| Play capacity (users) | 8 |
| Colour options |  |



Playhouse, GreenLine

BASIC752



Seating area with tables and benches

Social-emotional: gathering, sharing, chatting - all train social skills.

Cognitive: suggests a theme and supports dramatic play, which stimulates languages and communication skills.



Transparency

Social-emotional: the transparency makes possible cooperation and communication throughout, all important life-skills for children to learn.



Window and counter holes

Social-emotional: invite sharing and cooperation on both sides.

Cognitive: supports dramatic play and imagination, and stimulates language and communication skills in children.



High desk

Physical: crawl under and peep over, training spatial awareness.

Social-emotional: gathering, sharing, chatting - all train social skills.

Cognitive: suggests a theme and supports dramatic play, which stimulates languages and communication skills.

Playhouse, GreenLine

BASIC752



Panels of 19mm EcoCore™. EcoCore™ is a highly durable, eco friendly material, which is not only recyclable after use, but also consists of a core produced from 100% recycled post consumer material from food packing waste.

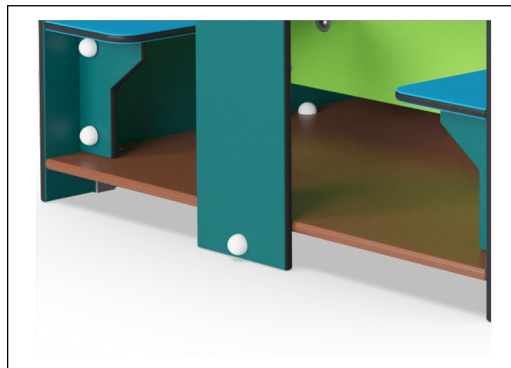

The floor is made of 21,5mm thick plywood made from alder and pine wood. Both sides are covered by 2 layers of phenolic film with anti slip net pattern. All cutting edges are sealed with paint to ensure long lifetime

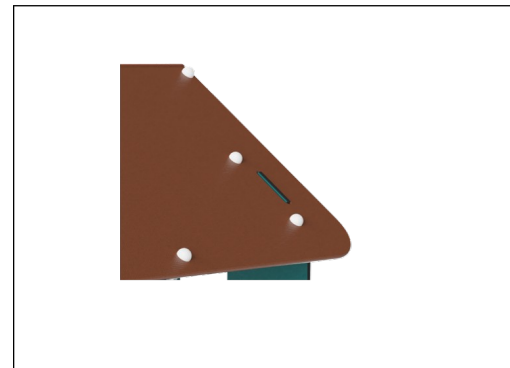

The roof is made of 16mm thick plywood made from alder and pine wood. Both sides are covered by 2 layers of phenolic film with anti slip net pattern. All cutting edges are sealed with paint to ensure long lifetime



KOMPAN GreenLine versions are designed with ultimate environmentally friendly materials with lowest possible CO2e emission factor such as EcoCore™ panels of 100% post consumer recycled ocean waste.

Item no. BASIC752-3418P

Installation Information

| | |
|--------------------------|---------|
| Max. fall height | 38 cm |
| Safety surfacing area | 18.0 m2 |
| Number of installers | 2 |
| Total installation time | 6.7 |
| Excavation volume | 0.12 m3 |
| Concrete volume | 0.00 m3 |
| Footing depth (standard) | 60 cm |
| Shipment weight | 191 kg |
| Anchoring options | |

Warranty Information

| | |
|------------------------|----------|
| EcoCore HDPE | Lifetime |
| Plywood | 5 years |
| Spare parts guaranteed | 10 years |





| Cradle to Gate A1-A3 | Total CO ₂ emission | CO ₂ e/kg | Recycled materials |
|-----------------------|--------------------------------|-------------------------|--------------------|
| | kg CO ₂ e | kg CO ₂ e/kg | % |
| BASIC752-3418P | 144.40 | 1.05 | 54.40 |

The overall framework applied for these factors is the Environmental Product Declaration (EPD), which quantifies "environmental information on the life cycle of a product and enable comparisons between products fulfilling the same function" (ISO, 2006). This follows the structure and applies a Life-Cycle Assessment approach to the entire Product stage from raw material through manufacturing (A1-A3))

Kompan A/S
C.F. Tietgens Boulevard 32C
DK-5220 Odense SØ
Denmark



Validation of CO₂ calculation of: Themed play systems

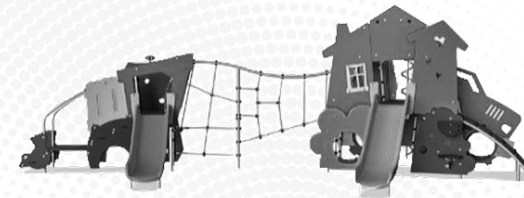

Data version no. 2021-09-27

The CO₂ calculation and data are in compliance with the principles of a carbon footprint impact according to the GHG protocol (Greenhouse Gas Protocol), Scope 3, cradle to gate related to all individual components in the product category: "Themed play systems" represented by item no.: MSC641100-3717P.

(Scope 3 emissions include emission sources in the upstream and downstream value chain).

Date: 15. October 2021 | Valid until: 15. October 2023

Validated by:

Bente Hviid

Bente Hviid, Senior Consultant

Peter Bendtsen

Peter Bendtsen, Senior Consultant

Validation based on report: Validation of CO₂ calculation of 8 categories of Kompan product line, version 1.0, prepared by: Bureau Veritas HSE, Denmark: Bente Hviid and Peter Bendtsen.

Publication date: 15. October 2021

By Bureau Veritas HSE
www.bureauveritas.dk
+45 7731 1000



Playhouse, GreenLine

BASIC752

* Max fall height | ** Total height | *** Safety surfacing area

* Max fall height | ** Total height

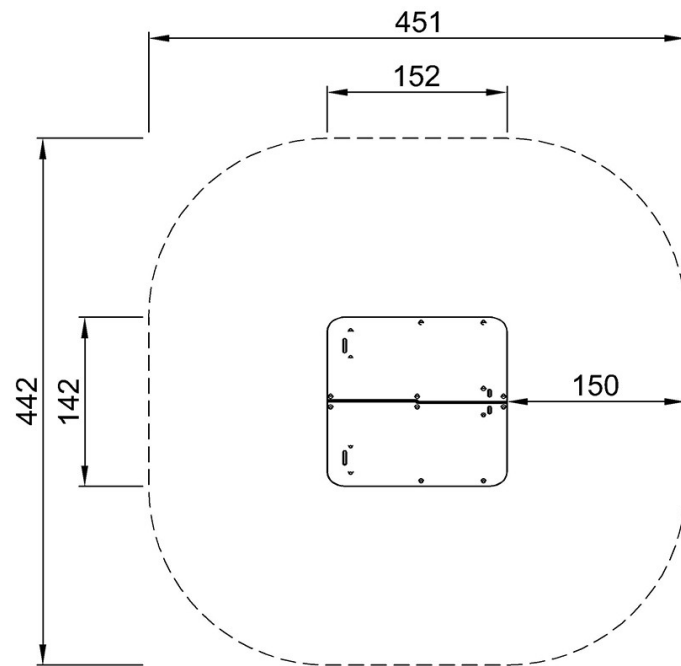

BASIC752
*38cm
**147cm
***18m²

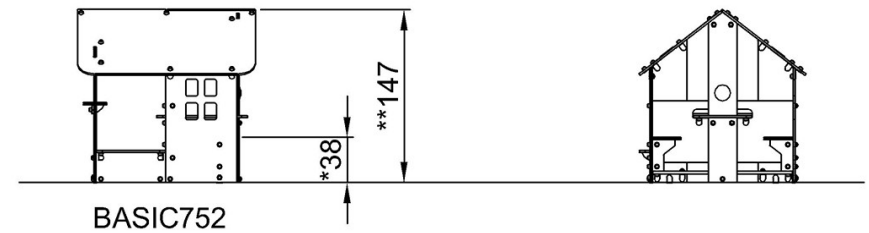

[Click to see TOP VIEW](#)

[Click to see SIDE VIEW](#)