

Construction are made from glued wood, galvanized steel and HDPE.

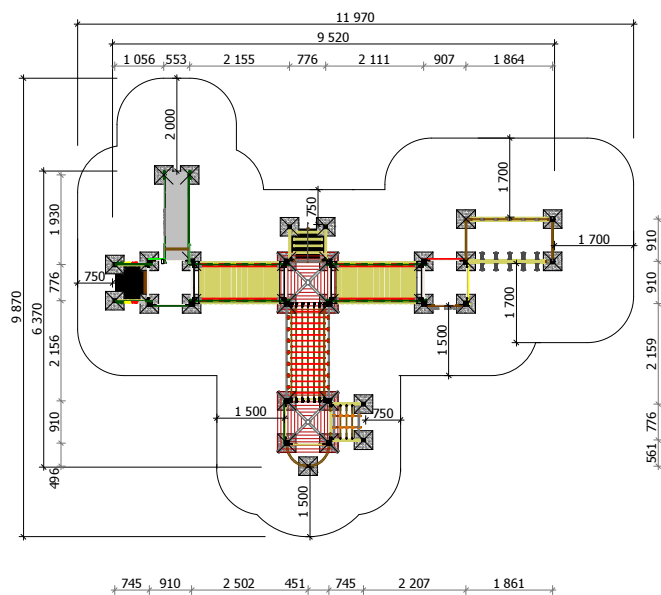

25 children

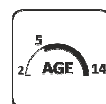

Children from 5 - 14 years

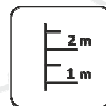

The Fall height
H=1.80 m



Weight
585 kg



Assembly
15 h
(without excavation and concreting)

Minimal required area - 70 m²

Length: 9 520 mm
Width: 6 370 mm
Height: 3 180 mm

Playground are provided for outdoor use in supervising of adults

Length of safety area: 11 970 mm
Width of safety area: 9 870 mm
Required safety area: 70 m²

Do not place stainless steel slide directly to south!

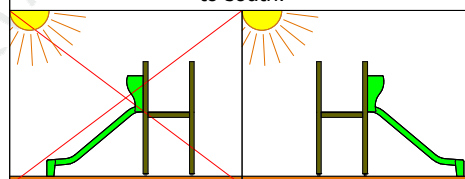

Equipment safety checkings must be performed once in a week in high vandalism risk areas.

Maintenance are required once in every 3 months, depending on usage

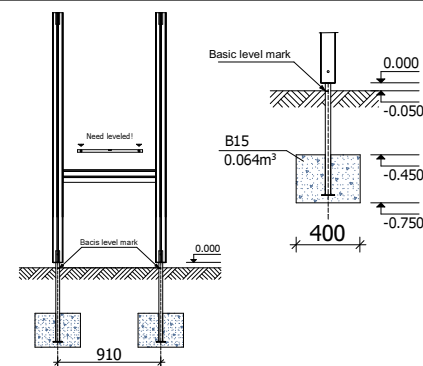

Adequate temperature

T_{min} -33.2 °C
T_{max} +64.4 °C



Snow load

1.05 kN/m²



Wing load

Stiprums 414.11 N

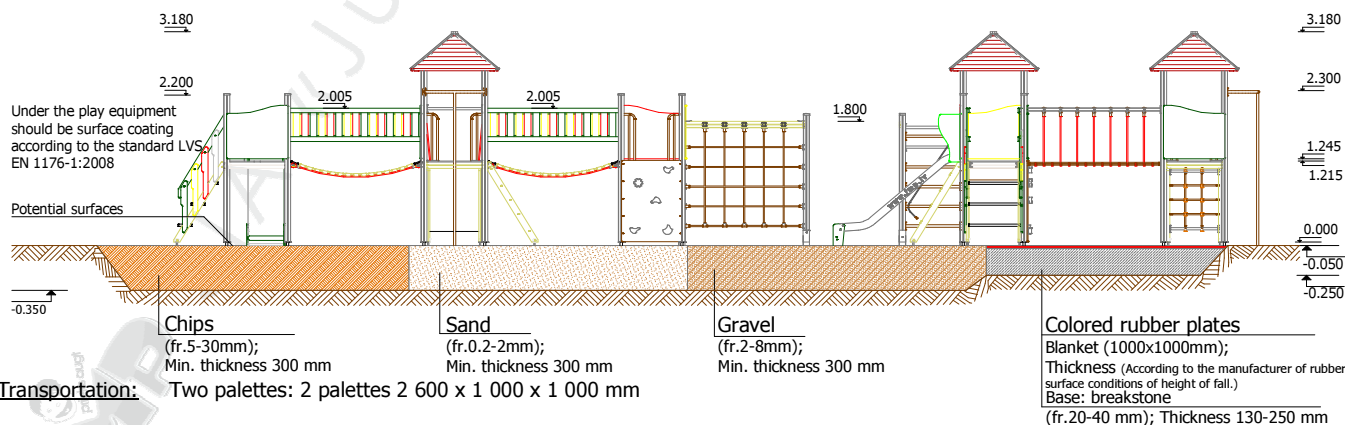

Transportation: Two palettes: 2 palettes 2 600 x 1 000 x 1 000 mm

Spare parts: All needed spare parts and elements, when warranty time expires can be ordered in „Jūrmalas Mežaparki” Ltd., and all the goods will be ready for delivery in 3 days.

According to LVS EN 1176:2008

Manufactured according to:

