

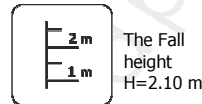

Construction are made from glued wood, galvanized steel and HDPE.

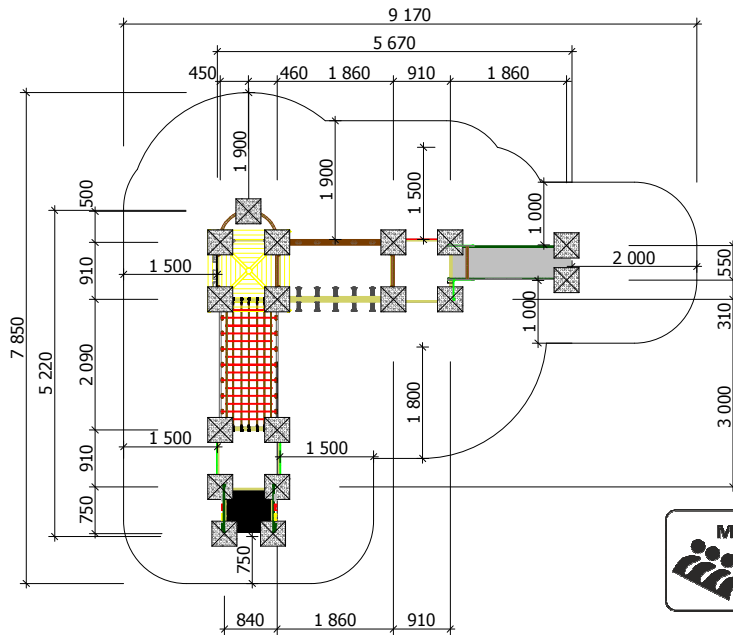

Minimal required area - 53 m<sup>2</sup>

Length: 5 670 mm  
Width: 5 220 mm  
Height: 3 180 mm

Playground are provided for outdoor use in supervising of adults

Length of safety area: 9 170 mm  
Width of safety area: 7 850 mm  
Required safety area: 53 m<sup>2</sup>

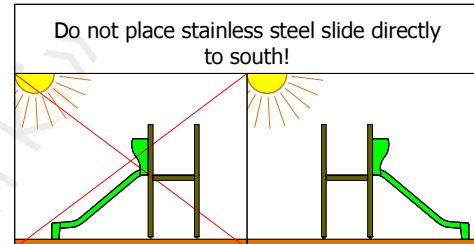

Equipment safety checkings must be performed once in a week in high vandalism risk areas.

Maintainance are required once in every 3 months, depending on usage

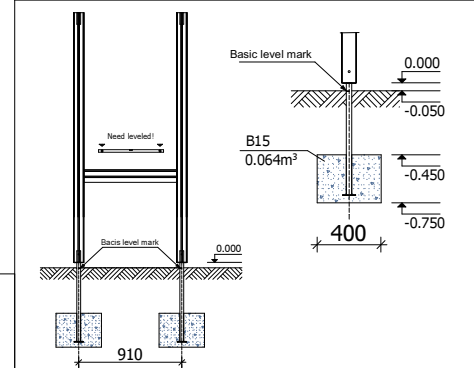

Play equipment are established with concreted steel foundation in equipment location. Equipment are suitable for use in two days after concreting, when the foundation are totally solid. During assembling there are not children allowed in area.

### Adequate temperature

T<sub>zemākā</sub> -33.2 °C  
T<sub>augstākā</sub> +64.1 °C



### Snow load

1.13 kN/m<sup>2</sup>



### Wing load

Stiprums 426 N

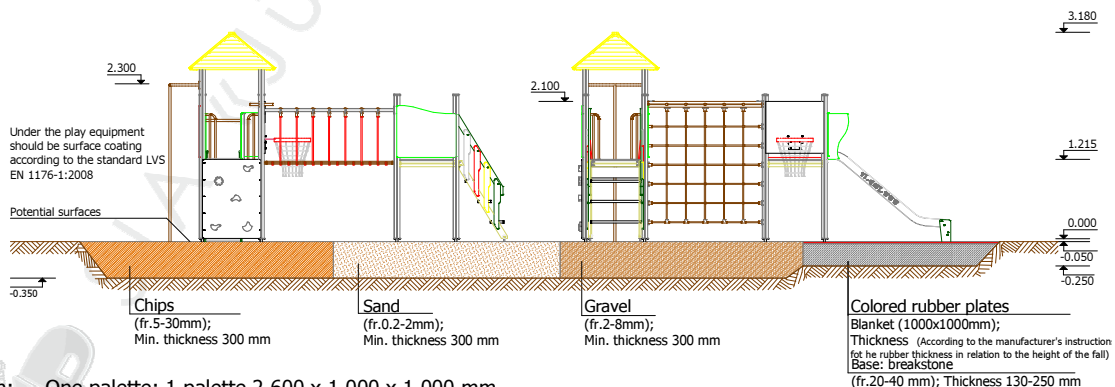

**Transportation:** One palette: 1 palette 2 600 x 1 000 x 1 000 mm

**Spare parts:** All needed spare parts and elements, when warranty time expires can be ordered in „Jūrmalas Mežaparki” Ltd., and all the goods will be ready for delivery in 3 days.

