

Rampa V

ref. EDMGV008

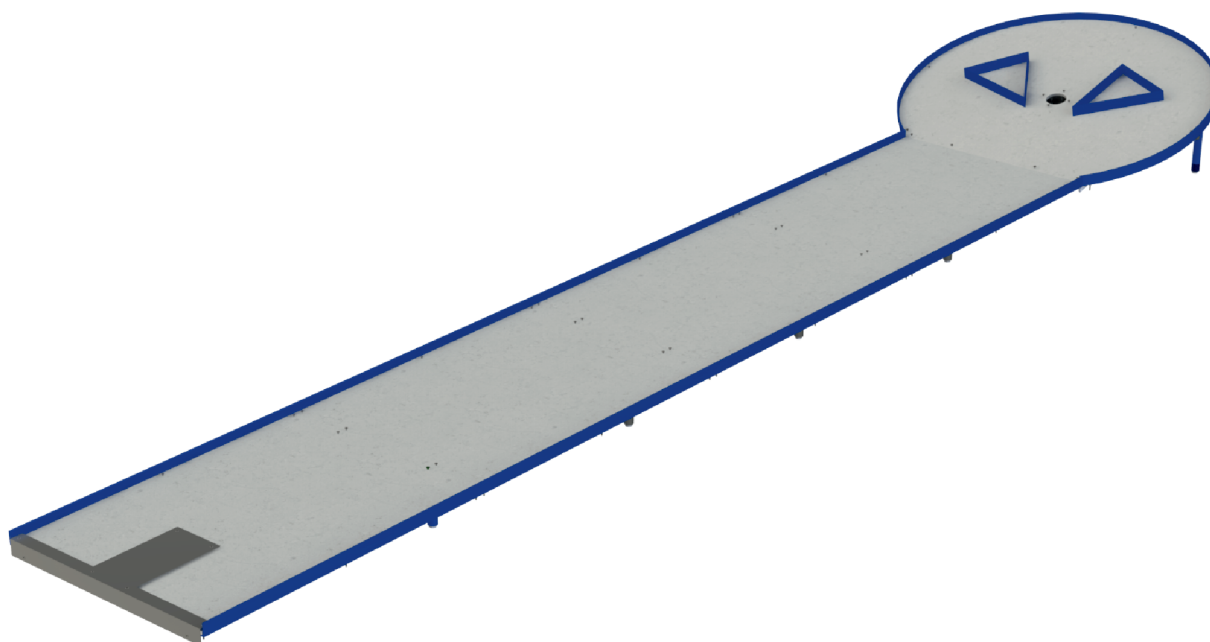

www.bragmaia.com



+4 Years

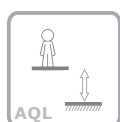

0 m

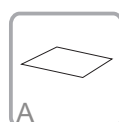

20 m2

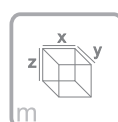

**x= 6,20
y= 1.40
z= 0.40**

Data Sheet

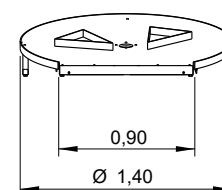
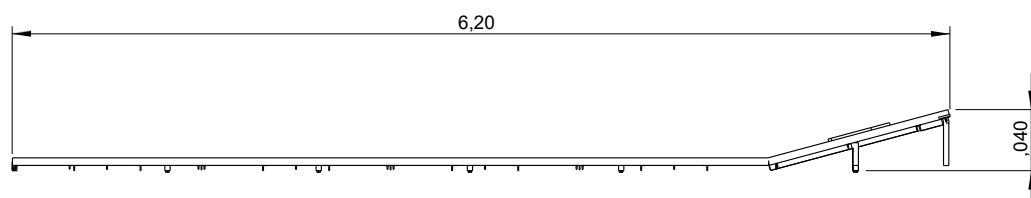

Equipment Information:



www.bragmaia.com

— Impact area

- - Free space

EN 1176-1,3

.....	①
	0
	20
	20

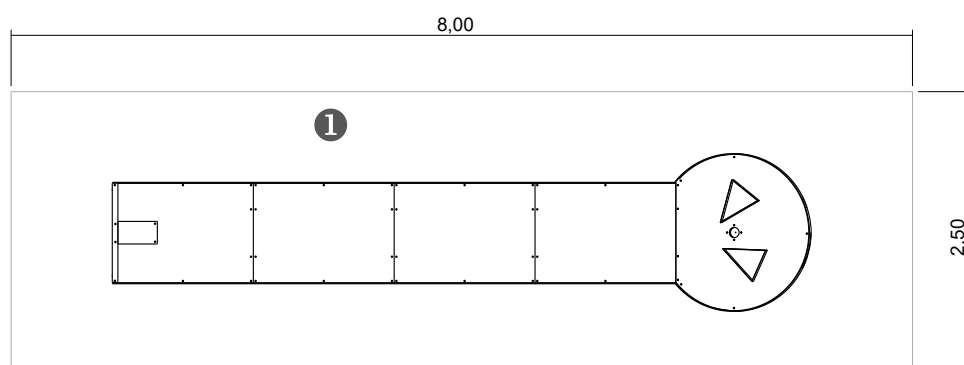

Technical Information:

1 - Mini-Golfe Rampa V

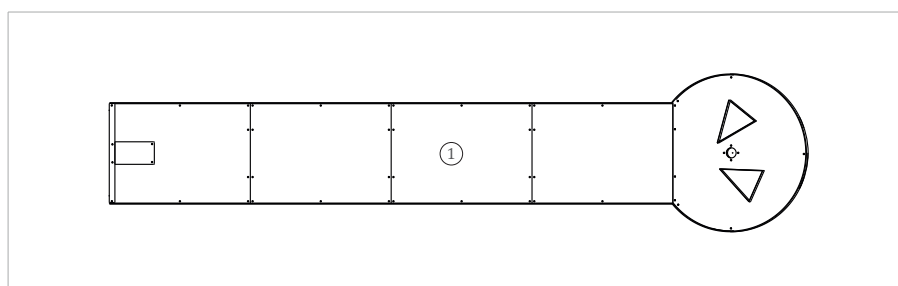

Technical Characteristics:



Structure

Iron: Electrozinc and gel type lacquer at 230°C with thickness ranging from 50 to 70µm, according to the UNE EN ISO 2808;

Fixation System:

Type B - Standard fixation system composed by steel base screwed to the ground with steel anchors;

Screws and accessories

Screws: Galvanized steel or optionally stainless steel AISI 304;

Optional: Synthetic turf base in polypropylene fiber,, height 6mm, green color, 98.500 points/m², density of 2.200 dtex and UV resistant (ref.: EDMGV008);



100% recyclable;

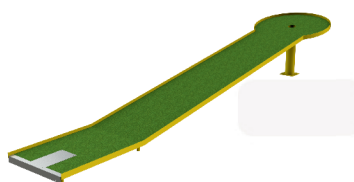

Synthetic Turf Base

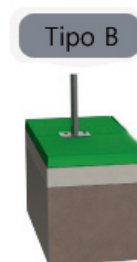

Systèmes de Fixation

Playful Activities:



Play: Develops both patience, sharing and sportsmanship.