



The Speeder offers a new type of riding position, the handholds are located to the sides and the front is fully open. The child climbs up, places feet on the sturdy footrests, grabs hold of the rubbery steering gear and is ready for take off.

Product Line	Traditional Play
Category	Springers
Age group	2 - 6
Max. fall height (CM)	60
Total height (CM)	60
Safety Zone	5.7 m ²



IN-
GROU.



ASTM

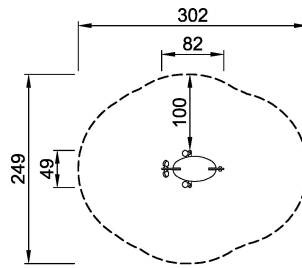

ELE400019E
*60cm
**60cm
***5.7m²
1:100

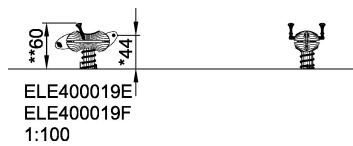

ELE400019E
ELE400019F
1:100

* = Highest designated play surface.
** = Total height of product.

Weight/heaviest parts	kg.	Installation (Manpower)	Persons
Concrete required	NaN m ³	Installation (Hours)	Hours
Foundation amount/footing	NaN	Excavation	NaN m ³