

The springer is a playground classic with a strong appeal to all children. Every springer in our range is just waiting for a child to unlock its imaginative potential.

<b>Product Line</b>	Traditional Play
<b>Category</b>	Springers
<b>Age group</b>	2 - 6
<b>Max. fall height (CM)</b>	60
<b>Total height (CM)</b>	73
<b>Safety Zone</b>	8.5 m2



**SUR-  
FACE**



**ASTM**

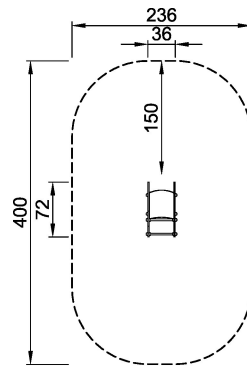

PCM103  
\*60cm  
\*\*73cm  
\*\*\*8,5m<sup>2</sup>  
1:100

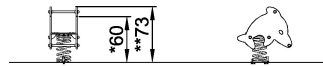

PCM103  
1:100

\* = Highest designated play surface.  
\*\* = Total height of product.

<b>Weight/heaviest parts</b>	kg.	<b>Installation (Manpower)</b>	Persons
<b>Concrete required</b>	NaN m3	<b>Installation (Hours)</b>	Hours
<b>Foundation amount/footing</b>	NaN	<b>Excavation</b>	NaN m3