

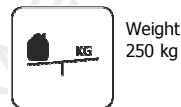

Construction are made from wood, galvanized steel and plywood.

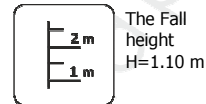
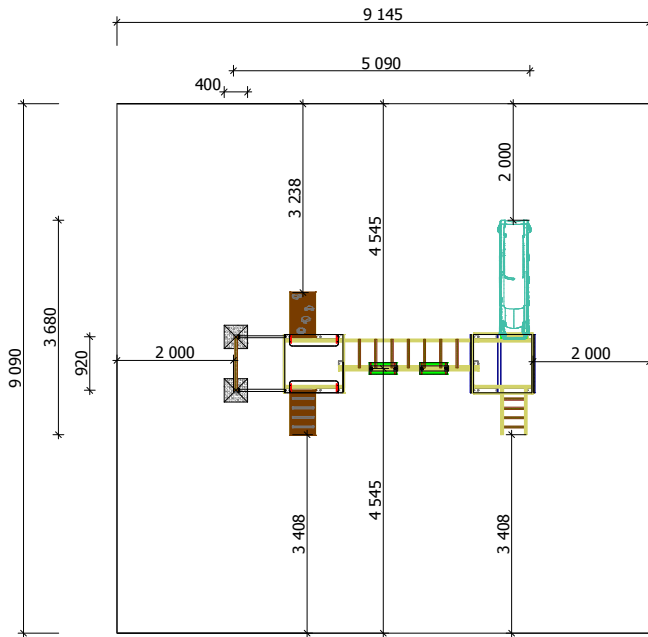

Minimal required area - 80 m²

Length: 5 090 mm
Width: 3 680 mm
Height: 2 700 mm

Length of safety area: 9 145 mm
Width of safety area: 9 090 mm
Required safety area: 80 m²

Do not place stainless steel slide directly to south!

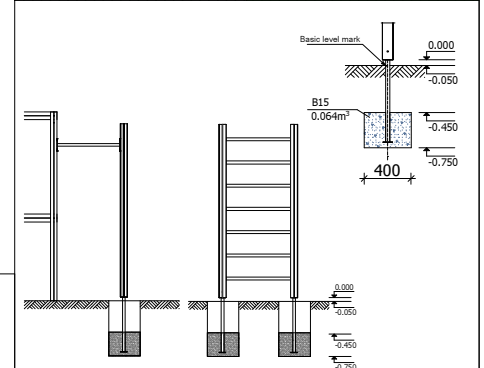
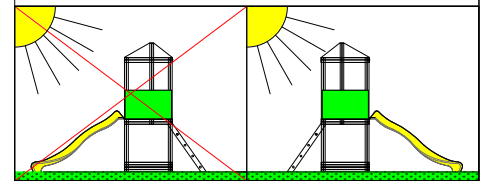

Play equipment are established with concreted steel foundation in equipment location. Equipment are suitable for use in two days after concreting, when the foundation are totally solid. During assembling there are not children allowed in area.

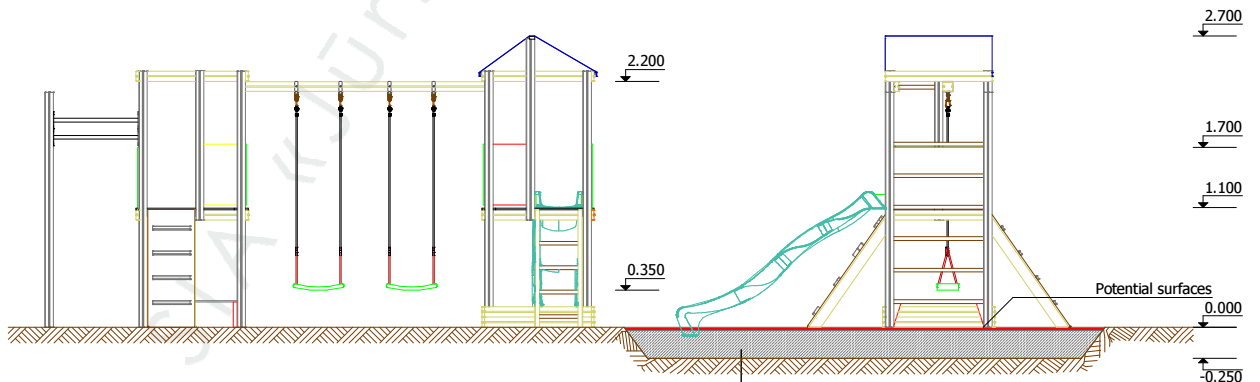

Transportation: One palette: 1 palette 2 600 x 1 000 x 700 mm

Colored rubber plates
Blanket (1000x1000mm);
Thickness 40 mm
Base: breakstone
(fr.20-40 mm); Thickness 130-250 mm

Spare parts: All needed spare parts and elements, when warranty time expires can be ordered in „Jūrmalas Mežaparki” Ltd., and all the goods will be ready for delivery in 3 days.