

Workout Parallel Bars

ref. SW003I

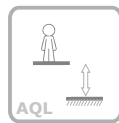

+12 Years



1.00 m

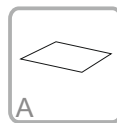

16 m²

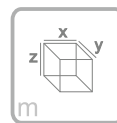

**x= 1,54
y= 0.65
z= 1.07**

Data Sheet

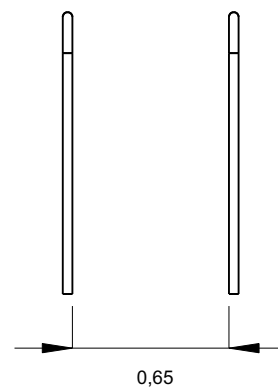
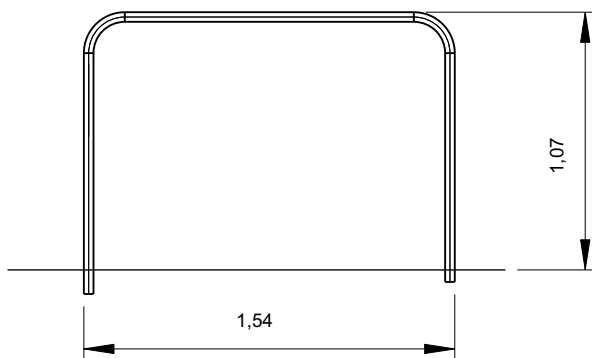

Equipment Information:

— Impact area
 - - Free space

EN 1176-1

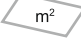

.....	!
	1,00
	16
	16

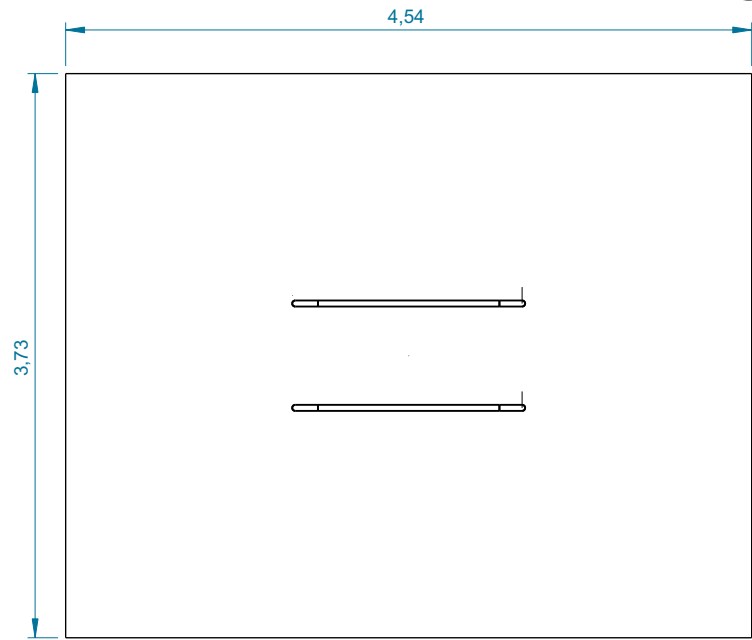

0,2 m³



6h



2x



KG



KG



Technical Information:

1 - Parallel Bars  1.00m

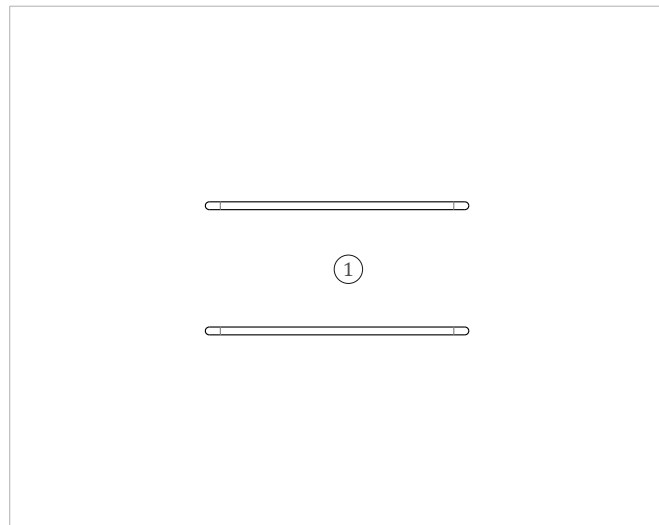

Technical Characteristics:

Metal Parts

Tubes:

Stainless steel: AISI 304, Ø40mm;

Fixation System:

Type C - Standard fixation system composed by posts applied directly in the ground with concrete;



100% recyclable;

